

NOTE:

- Pavement tree plantings are to be a minimum size of 200 litres.

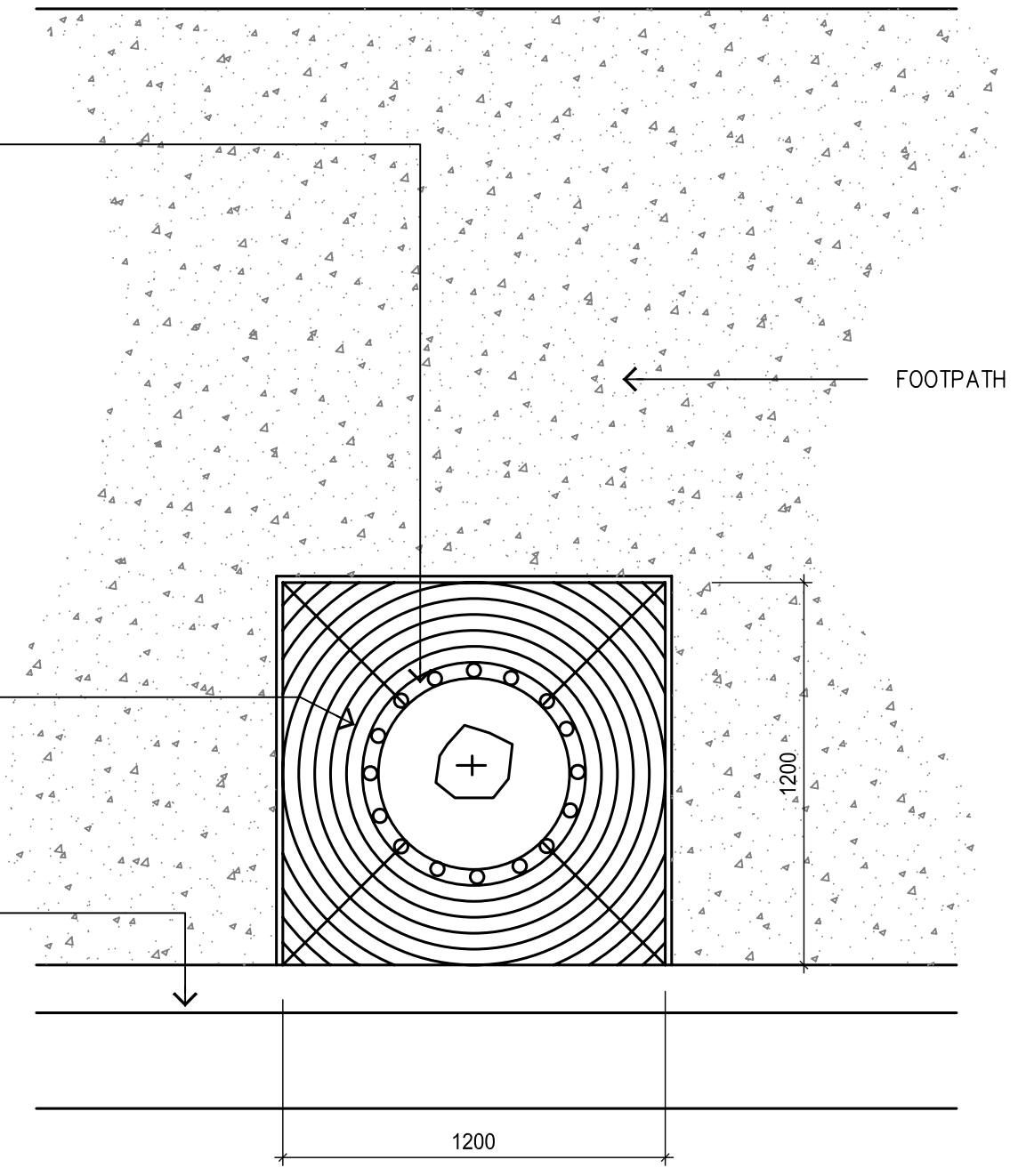
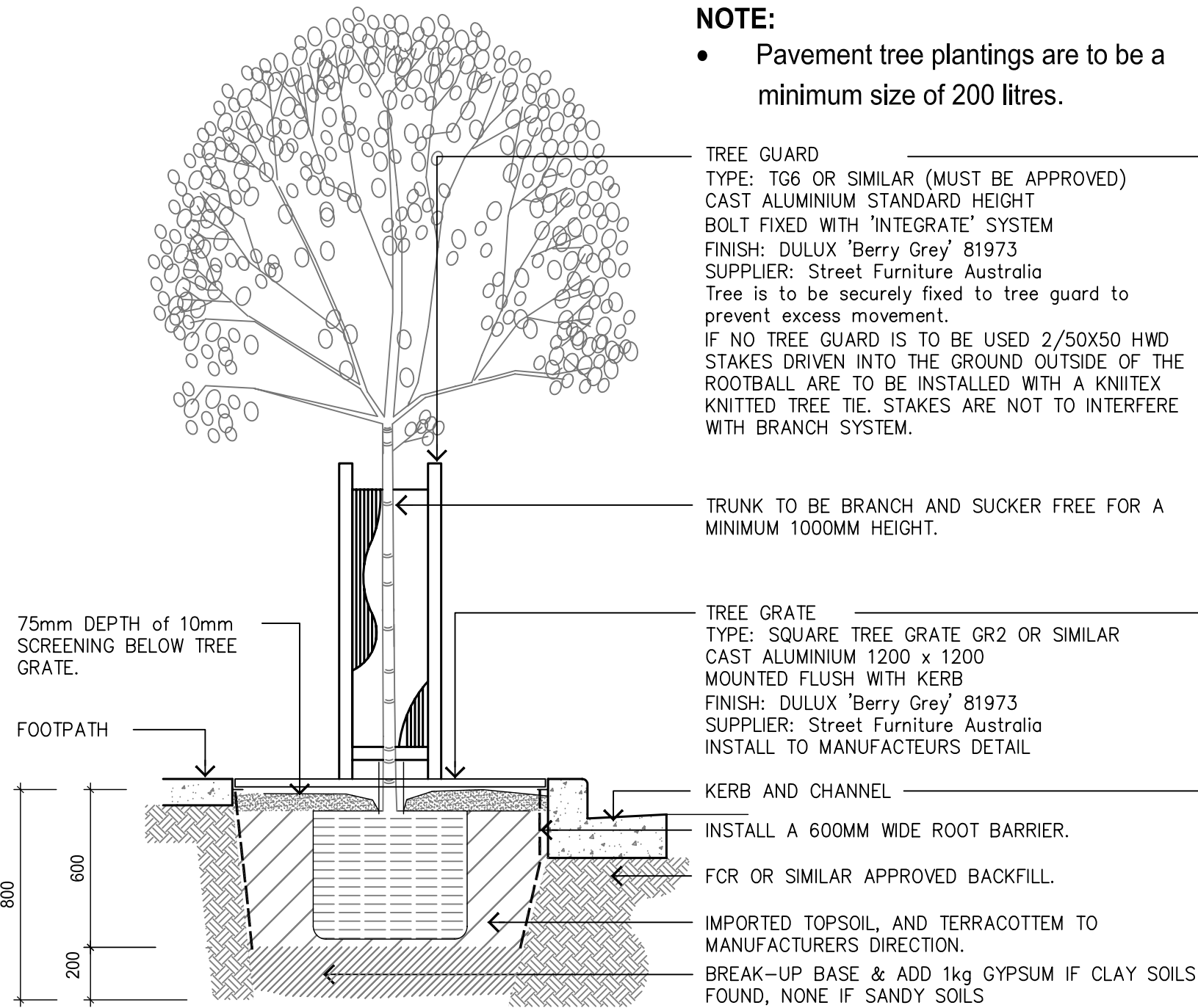

PAVEMENT TREE PLANTING DETAIL

SECTION 1:30

PLAN VIEW 1:30

ADVANCED TREES SHALL BE CONTAINER GROWN WITH STURDY SINGLE STRAIGHT TRUNK OF SPECIFIED POT & CALIPER SIZE, SELF-SUPPORTING, HARDENED-OFF & DISEASE FREE.
 TREES SHALL BE WELL ROOTED WITHOUT INDICATION OF ROOT CURL, RESTRICTION OR DAMAGE.
 EXCAVATE PLANTING HOLE TWICE SIZE AND DEPTH OF POT & BREAK-UP BASE OF HOLE WITH CROWBAR. ADD 1kg OF AG. GYPSUM.
 REMOVE TREE FROM CONTAINER.
 TREE SHALL BE POSITIONED IN THE CENTRE, PLUMB.
 THOROUGHLY MIX TERRACOTTEM® WITH TOPSOIL TO MANUFACTURERS DIRECTION.
 BACKFILL TREE HOLE WITH IMPORTED TOPSOIL, AS SPECIFIED, & PROGRESSIVELY COMPACT, INSTALLED TRUNK COLLAR GUARD AS SPECIFIED.
 INSTALL MINIMUM 2/HWD STAKES AND KNIITEX KNITTED NYLON TREE TIE IF NO TREE GUARD IS TO BE USED, TIE TREE TO GUARD AS ALTERNATIVE. AVOIDING ROOTBALL DAMAGE.
 GRADUALLY WATER-IN IMMEDIATELY AFTER PLANTING WITH 50lt PER TREE TO ENSURE THOROUGH WETTING OF ROOTBALL & SETTLING OF BACKFILL. TOP-UP SOIL AS REQUIRED AFTER SETTLEMENT.
 FINISH WITH 75mm LAYER OF 18mm SCREENINGS OR MULCH IF NO TREE GRATE.

A	ORIGINAL ISSUE	I.B.	8.2008	
ISSUE	AMENDMENT DETAILS	INITIALS	DATE	



TWEED SHIRE COUNCIL
DESIGN UNIT

COUNCIL OFFICES
 TUMBLGUM ROAD,
 MURWILLUMBAH,
 NEW SOUTH WALES, 2484

PHONE MURWILLUMBAH 02 66702400
 FAX MURWILLUMBAH 02 66727513
 WEBSITE www.tweed.nsw.gov.au

DESIGN ENGINEER	T.A.B.H.		DATE	8.2008
CHECKING ENGINEER	[Signature]		DATE	8.2008
DESIGNED		DESIGN NO.		
DRAWN	I.B.	8.2008	SURVEY NO.	
CHECKED	S.B.	8.2008		
HORIZONTAL DATUM		REDUCTION RATIO	PM	
VERTICAL DATUM			EN	

PROJECT:	LANDSCAPING STANDARDS	DRAWING NUMBER:	S.D.705
PLAN TITLE:	TREE PLANTING IN PAVEMENT DETAIL	SHEET 1 OF 1 SHEETS	
		ISSUE A	