

**Notes**  
 Architectural drawings only. Refer to and co-ordinate with all other contract documents.  
 Use figured dimensions only.  
 Contractor to verify all dimensions prior to commencement of work.  
 Any doubt, ambiguity or omission of any part of the drawing or the specifications shall be referred to the architect for clarification prior to commencement of work.  
 Submit shop drawings of all assemblies for review prior to manufacture.

Approved for Construction  
 Signed \_\_\_\_\_ Dated \_\_\_\_\_

No.	Date	Description	App.
A	22.10.2009	FOR INFORMATION	
B	04.11.2009	FOR INFORMATION	
C	16.11.2009	FOR INFORMATION	
D	04.12.2009	FOR INFORMATION	
E	04.12.2009	FOR INFORMATION	
F	26.11.2010	FOR INFORMATION	
G	10.12.2010	FOR INFORMATION	
H	22.12.2010	FOR INFORMATION	
J	10.01.2011	FOR INFORMATION	
K	11.03.2011	FOR INFORMATION	
L	22.06.2011	FOR INFORMATION	
M	23.06.2011	FOR INFORMATION	
N	22.06.2012	FOR INFORMATION	
P	26.06.2012	FOR INFORMATION	
Q	03.07.2012	FOR INFORMATION	
R	27.07.2012	FOR INFORMATION	
S	17.08.2012	FOR INFORMATION	
T	21.08.2012	FOR INFORMATION	

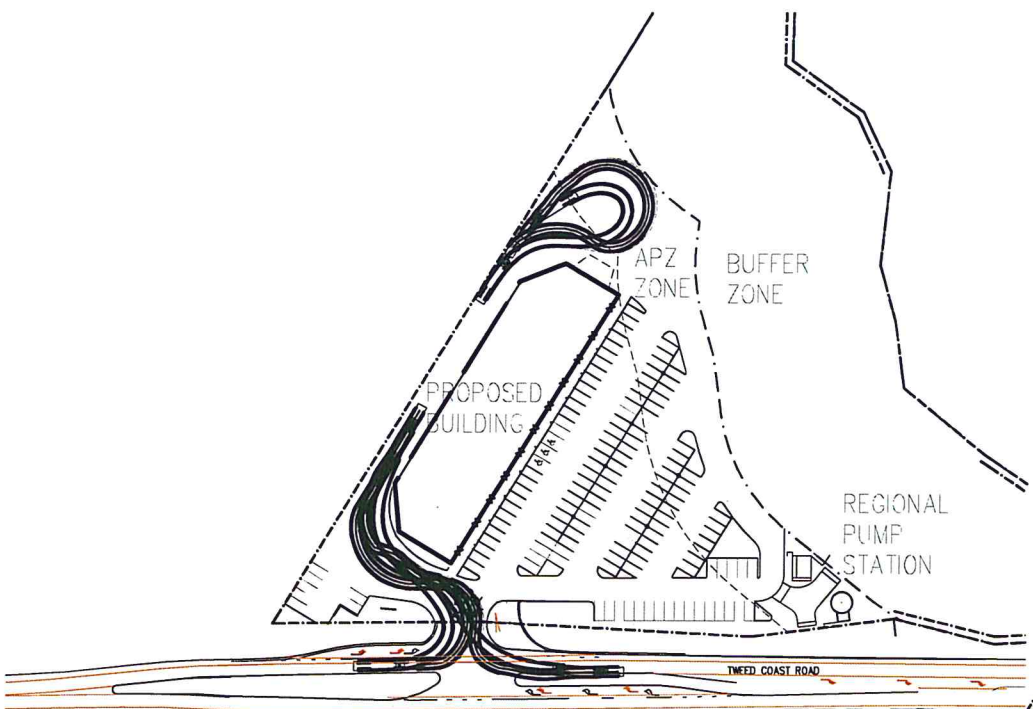

NSW GOVERNMENT  
 Planning  
 Issued under the Environmental Planning and Assessment Act 1979  
 Approved Application No. 08\_0194  
 granted on the 11 August 2013  
 Signed [Signature]  
 Sheet No. 39 of 41

**2 SITE PLAN**  
 001 SCALE 1:1000 @ A1 & 1:2000 @ A3

LEGAL DESCRIPTION:  
 LOTS 7  
 DP 875447

AREA SCHEDULE:

KINGS FOREST 2009			
NAME OF THE BUILDING	FLOOR AREA (M <sup>2</sup> )	CARS /100m <sup>2</sup>	CAR REQUIRED
BUILDING	2036	5.4	109.9
<b>SUB TOTAL</b>		<b>CARS REQUIRED</b>	<b>110</b>
		<b>CARS ACHIEVED</b>	<b>135</b>
		<b>INCL STAFF CAR PARK</b>	<b>7</b>
		<b>INCL BACK UP CAR PARK</b>	<b>15</b>

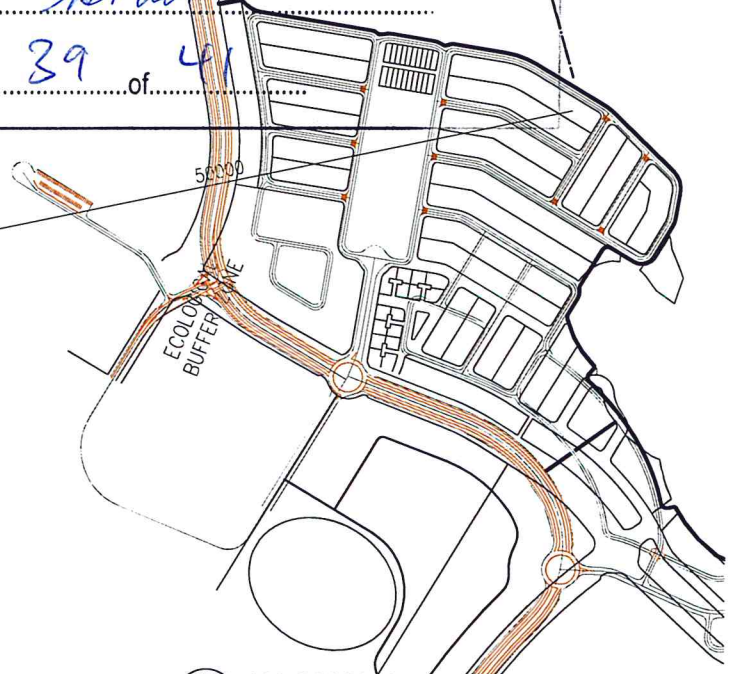
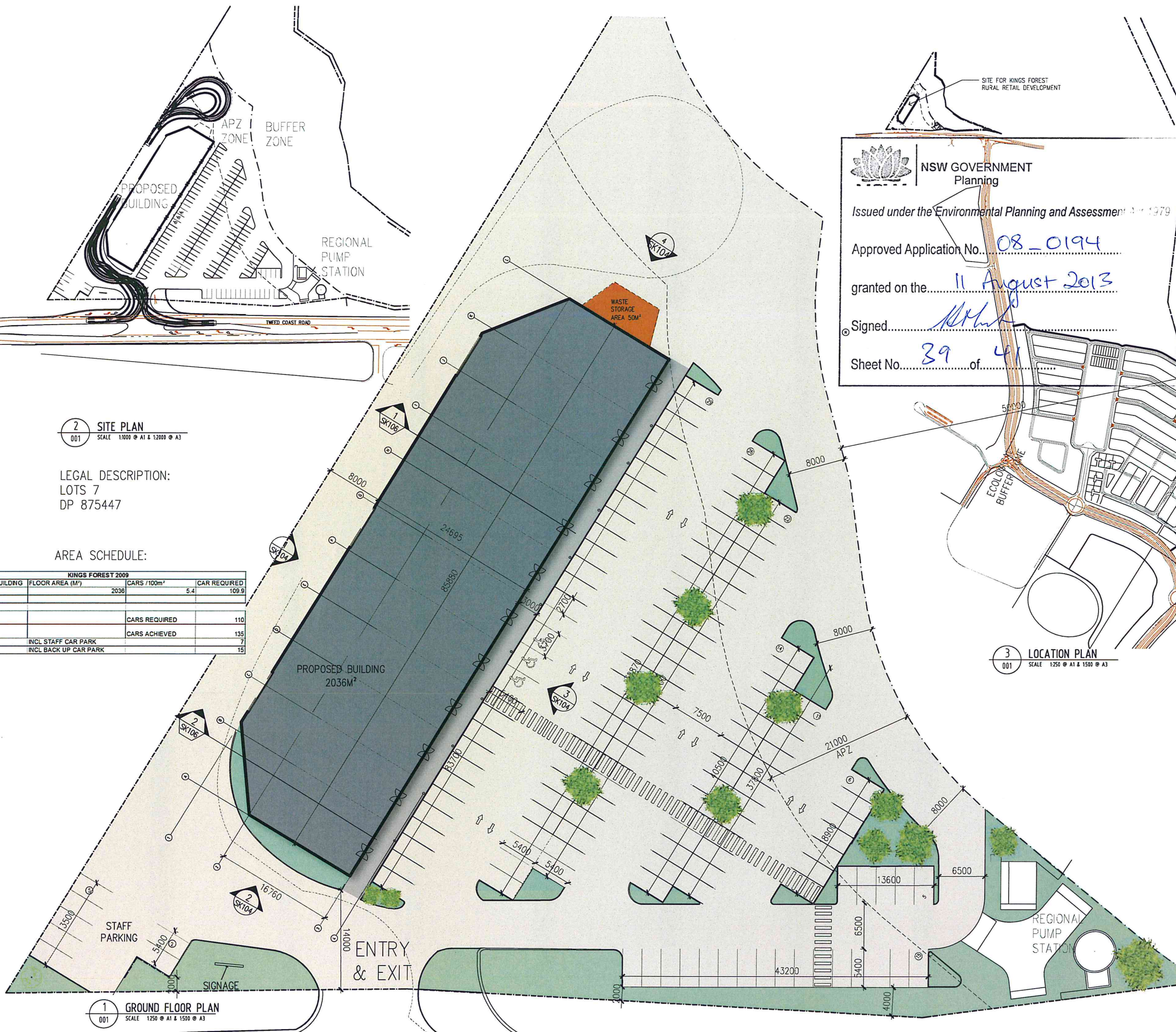

**3 LOCATION PLAN**  
 001 SCALE 1:250 @ A1 & 1:500 @ A3

**1 GROUND FLOOR PLAN**  
 001 SCALE 1:250 @ A1 & 1:500 @ A3



Makoto Buchan Laird & Brewster (NZ) Pty Ltd  
 Level 2, 51 Carrington Terrace (PO Box 1325) Christchurch 8140 NEW ZEALAND  
 E-mail: info@thebuchan.co.nz Tel: (+64 3) 377 2973 Fax: (+64 3) 377 2998  
 1 Little High Street, 55-57 High Street (PO Box 2443) Auckland 1140 NEW ZEALAND  
 E-mail: info@thebuchan.co.nz Tel: (+64 9) 363 1451 Fax: (+64 9) 363 1452

The Buchan Group - an association of independent practices with several abilities  
 Project  
**KINGS FOREST RURAL SUPPLIES DEVELOPMENT**

Doc Title  
**SITE PLAN & LOCATION PLAN**

Purpose  
**PRELIMINARY**

Date 21.08.2012	Drawn CAD	Checked
Scale <b>AS SHOWN</b>	Cal. Ref.	
Job No. 709198		
Doc No. <b>SK001</b>		